

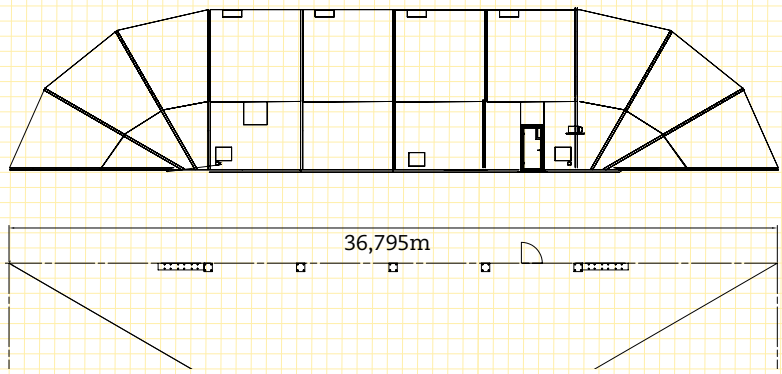

## Cross section drawing

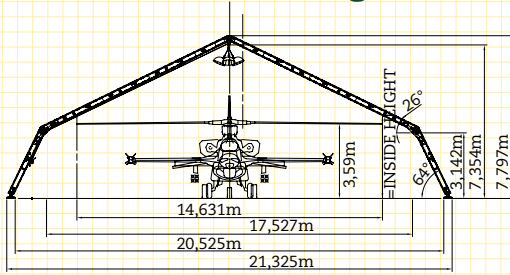

## Ground plan

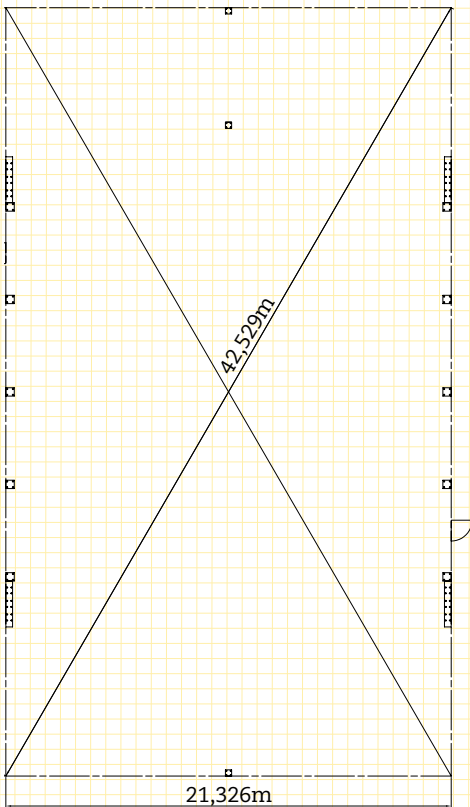

## Construction

The construction of the shelter is composed of lightweight anodised aluminium profiles with a free span without any supporting poles. The steel sections are galvanised. The shelter can be moved easily and does not require any foundations. The anchoring system can be used both in sandy and hard grounds, light rocky ground and concrete. 3 types of anchors are included: steel pins for gravel or hard sand, screw anchors for soft ground and concrete anchors for concrete floors. The stability is ensured using wind bracing. The MSS complies with the strictest international building standards.

## Roof and gable fabrics

Roof and gable fabrics are made from PVC coated polyester fabric in two-colours with a sand colour on one side and olive green on the other, this is for optimal use in any military situation. The roof fabric is supported by the construction and are stretched vertically with tension tubes. The roof fabric is designed so that there are no openings through which rain, dust or snow could penetrate the shelter, even with wind speeds of up to 74 km/h. There are no places for water to collect. Flame retardant according to the French standard M2, German standard DIN 4102 B1 and British Standard BS 5438. The fabric is UV-stabilised and treated against deterioration due to rot and mildew. The fabric is not translucent, so that it prevents the transmission of light for inside to out and also the visibility of the shelter at night. The internal and external surfaces of the fabric are easy to clean.

### Technical specifications

Standard width	21,3 m
Standard length	36,9 m
Side height	3 m
Ridge height	7,3 m



Veldeman Structure Solutions ▶ Industrieterrein Vostert 1220 ▶ 3960 Bree (Belgium)

Tel.: +32 (0)89 47 31 31 ▶ Fax: +32 (0)89 47 37 77 ▶ E-mail: [info@veldemangroup.be](mailto:info@veldemangroup.be) ▶ Website: [www.veldemangroup.be](http://www.veldemangroup.be)